

Hidden Ridge - Fenton, MI

"Ranch Style"

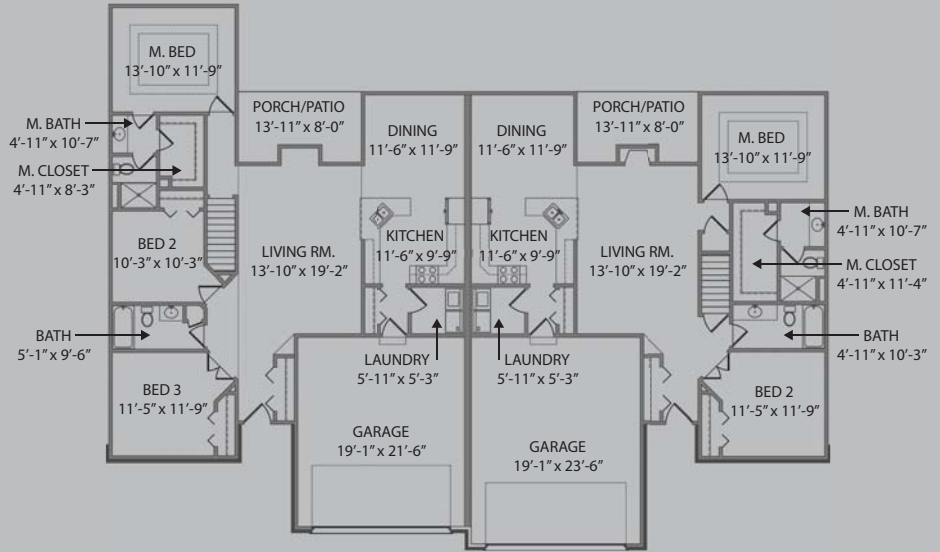

THREE BED UNITS

- 3 Bedroom
- 2 Bath
- Approx. 1600 sq. ft.
- Nicely Equipped
- Starting at:

\$259.9k

TWO BED UNITS

- 2 Bedroom
- 2 Bath
- Approx. 1300 sq. ft.
- Nicely Equipped
- Starting at:

\$249.9k

*picture of existing building for illustration purposes only. Actual building may vary.

BUILDING JUNKIES STANDARDS:

- 2x6 exterior walls
- Anderson windows
- Upgraded Certainteed siding
- Upgraded Certainteed dimensional shingles
- Entire home/garage wrapped in Tyvek
- Upgraded interior doors
- Upgraded molding package
- Granite counters in Kitchen
- Upgraded cabinets
- Maintenance free exteriors
- Semi custom paint
- High efficient water heater
- And much much more!

AVAILABLE OPTIONS:

- Fireplace w/ white mantel \$2,897.00
- Stone on the fireplace \$2,145.00
- Upgraded distressed beam mantle \$650.00
- Ceramic backsplash \$2,466.00
- L.E.D. cabinet lighting package \$1,844.00
- Open basement stairs w/ railing \$2,980.00
- Finished basement pkg. (2-bed unit) \$28,500.00
- Finished basement pkg. (3-bed unit) \$31,500.00

**Price
your own
Condo!**

*plans, prices and options subject to change - call for details

"Realtors Welcome!"

Here are all the extras you will get when comparing the Building Junkies Condo's to the basic standard builder Condo.

	OTHER BUILDERS	BUILDING JUNKIES STANDARD		OTHER BUILDERS	BUILDING JUNKIES STANDARD
FOUNDATION			GOURMET KITCHEN		
8 ft poured concrete walls	STD	STD	Upgraded cabinets dove tail joints	extra	STD
9 ft superior poured walls	extra	STD	Upgraded cabinets no particle board	extra	STD
Basement interior walls insulated	extra	STD	Upgraded cabinets with soft close drawer	extra	STD
Basement interior walls studded for future finish	extra	STD	Upgraded choice of 7 cabinet doors to pick from	extra	STD
Hole prep for future electrical	extra	STD	Microwave prep package	extra	STD
Egress Window	STD	STD	Dishwasher prep package	extra	STD
			Water line to refrigerator	extra	STD
			Granite counter tops	extra	STD
			Stainless steel sink	extra	STD
			Prep for a gas or electrical range	extra	STD
			Wired for garbage disposal	extra	STD
STRUCTURE			INTERIOR FEATURES		
2x4 exterior walls	STD	STD	<i>Builder allowances for basic vinyl for the following</i>		
2x6 exterior walls	extra	STD	Foyer area, kitchen laundry room and all bathrooms	STD	STD
2x10 joists	STD	STD	Upgrade to premium engineered hard wood floors, foyer kitchen laundry rooms	extra	STD
Engineered T.G.I. Joists	extra	STD	Upgrade to ceramic in all bathrooms	extra	STD
2x4 interior walls	STD	STD	Upgraded carpet allowances	extra	STD
			Formica vanity tops	STD	STD
			Granite vanity tops	extra	STD
			Upgrade to 4 in. base/case moldings painted	extra	STD
			Upgrade to 4 1/2 in. base/case moldings painted	extra	STD
			ADA toilets with soft close lids	extra	STD
			Elegant master suite	extra	STD
			Upgraded pre-finished shelving in closets	extra	STD
			Master en-suite per plans	extra	STD
			Grohe Faucets	extra	STD
EXTERIOR			LIGHTING		
Garage and entire home wrapped in Tyvek	extra	STD	Builder grade allowances for recess lights	STD	STD
.42 mills siding upgrade	extra	STD	Allowances for recessed lights	extra	STD
Builder grade shingles	STD	STD	Ceiling fans in living room or allowance	extra	STD
Dimensional Certain Teed shingles	extra	STD			
Maintenance free fascia	extra	STD			
Maintenance free soffits	extra	STD			
ENERGY FEATURES					
Upgrade to Anderson low maintenance	extra	STD			
Blown in fiberglass R-21 exterior wall insulation	extra	STD			
R-49 ceiling insulation	extra	STD			
House and garage completely wrapped	extra	STD			
95% plus efficient furnace	extra	STD			
ELECTRICAL/MECHANICAL					
200 amp upgrades service panel	extra	STD			
Pre wired for ceiling fans and lights in all bedrooms	extra	STD			
Recess plug and cable jack for wall mount TV per plans	extra	STD			